

# OPEN EYE GALLERY



**ABOUT  
US**



## OPEN EYE GALLERY

Founded in 1977 Open Eye Gallery is an independent not-for-profit photography gallery based in Liverpool.

We are one of the UK's leading photography spaces, and the only gallery dedicated to photography and related media in the North West of England.

Open Eye has consistently championed photography as an art form that is relevant to everyone. We promote the practice, enjoyment and understanding of photography by creating challenging and entertaining opportunities to experience and appreciate distinctive, innovative photographs.

As well as presenting a programme of international, high-quality exhibitions we also house a permanent Archive containing photographs from the 1930s to the present day.

We support established and emerging artists, developing practical, critical and professional skills among photography practitioners; we also offer training and development opportunities to people within our local community.

## DIRECTIONS

Open Eye Gallery is a short walk from the [Liverpool ONE](#) shopping centre and the Albert Dock. The gallery is part of the new Mann Island development, a complex of three black buildings that sit between the Strand, the Canning dock and the new Museum of Liverpool. Our entrance is on the ground floor, in a covered public courtyard which can be entered from the south side (facing the Museum of Liverpool) or the north side (facing Mann Island and the Liver Building).

### By train

We are 20 minutes walk from Lime Street station – Liverpool's mainline railway station.

James Street station, served by Wirral Line trains, is a two minute walk. Moorfields station, served by the Northern and Wirral Lines, is a five minute walk. Visit [Merseytravel](#) for details of local train services.

### By bus

The nearest bus station is at Liverpool ONE, but some buses drop off at the Pier Head, right next door to the gallery. [Merseytravel](#) has details of local bus services.

### By ferry

The gallery is two minutes walk from the Pier Head Ferry Terminal, from which Mersey Ferries run regular services to the Wirral.

### By coach

The nearest coach station is on Norton Street (Liverpool city centre), served by National Express coaches.

Groups travelling by coach can visit the Liverpool Travel Trade website for information on suitable long stay coach parks.

### By car

Follow the brown signs to the Waterfront. The nearest multi-storey car park is Q-Park at Liverpool ONE, 35 Strand Street, Liverpool, L1 8LT.

There are six blue badge parking spaces about 40 metres from the entrance to the gallery. They are opposite the entrance to the Museum of Liverpool, beside the Great Western Railway building. The spaces need to be pre-booked by calling 0151 478 4545.

### By bicycle

There are bicycle bays close to the gallery, opposite the entrance to the Museum of Liverpool, beside the Great Western Railway building.





## ACCESSIBILITY

There is level access to the gallery entrance and the Mann Island covered public space where we are located. Inside the gallery there are two ground floor spaces joined by a flat corridor, an accessible toilet and a platform lift to the upper gallery. Assistance dogs are welcome.

**SPACES**



In November 2011 Open Eye Gallery re-launched in a brand new purpose-built home in one of the city's most prestigious and prominent new developments on the Liverpool Waterfront.

The gallery opens onto a large covered public square and is split over two floors. Open Eye Gallery hosts an international programme of cutting edge exhibitions showcased all year round, including periodic exhibitions reflecting on the gallery's Archive.

Open Eye Gallery also commissions Wall Works - large-scale graphic art installations for the external facade of the gallery. The gallery's position at the heart of the regenerated Waterfront - next to the Museum of Liverpool and a stone's throw from Tate Liverpool and Albert Dock - cements its commitment to the city and its vibrant cultural life.

## GALLERY 1

Located on the ground floor, Gallery 1 is ideal for welcoming guests with a glass of wine on arrival.

With a solid oak reception desk, polished concrete floor and double height ceiling the space is open, inviting and perfect for drinks receptions, meetings or lectures with direct access to the Covered Public Realm.

# 1

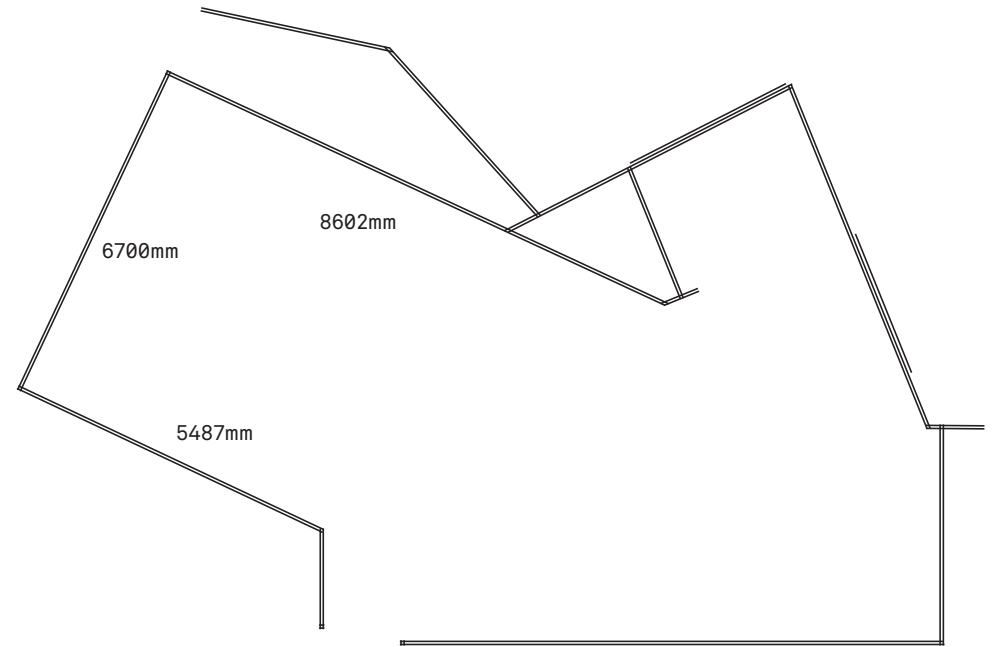

Dimensions  
901cm x 556cm x 546cm

Suitable For  
Wine receptions  
Discussions  
Presentations  
Team development  
Away days  
Meetings  
Book launches

Capacities  
Lecture for 40  
Drinks reception for 50  
Meeting for 12  
Cabaret style for 30  
(depending on  
exhibition layout)

Features  
Floor sunken  
electricity supply  
Open Eye Gallery Shop  
Reception Desk  
(with internet access)  
WIFI





## GALLERY 2

Located on the ground floor with full height glass windows overlooking the canal Gallery 2 is bright and spacious, ideal for large lectures, meetings and wine receptions.

Gallery 2 has a polished concrete floor and is connected to Gallery 1 via a solid wood panelled corridor making it ideal for larger events or multiple layouts where the two spaces can be used together.

# 2

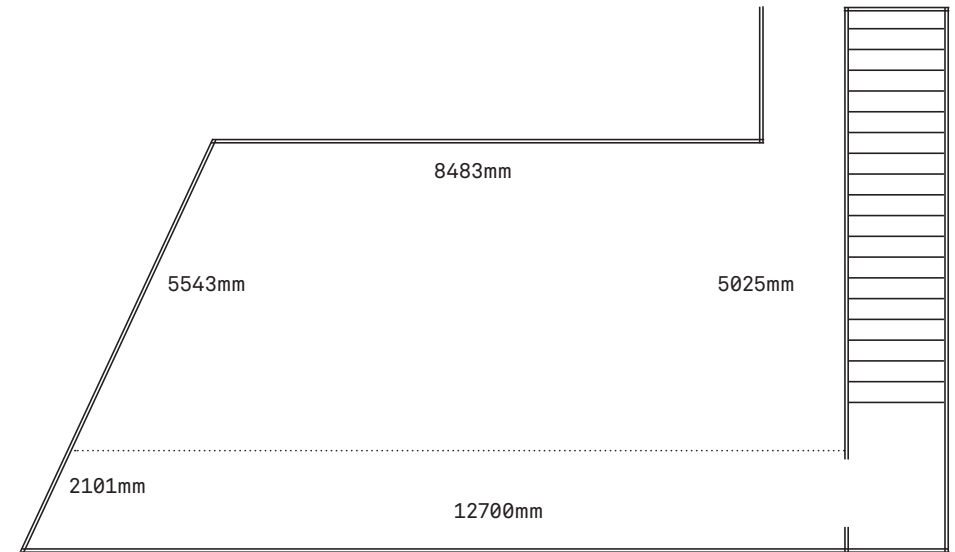

### Dimensions

554cm x 198cm x 526cm  
x 845cm

### Suitable For

Wine receptions  
Discussions  
Presentations  
Team development  
Away days  
Meetings  
Book launches

### Capacities

Lecture for 50  
Drinks reception for 75  
Meeting for 30  
Cabaret style for 50  
(depending on  
exhibition layout)

### Features

Ceiling electricity  
supply  
Full height windows  
Low level seating area



## UPPER GALLERY

The Upper Gallery is located on the 1st floor, with a solid wood floor and single height ceiling the space is ideal for more intimate settings, breakout space from the larger galleries or meetings.

Accessible via the stairs or platform lift, the Upper Gallery is a private yet versatile space with adjustable lighting to suit any event.

# 3

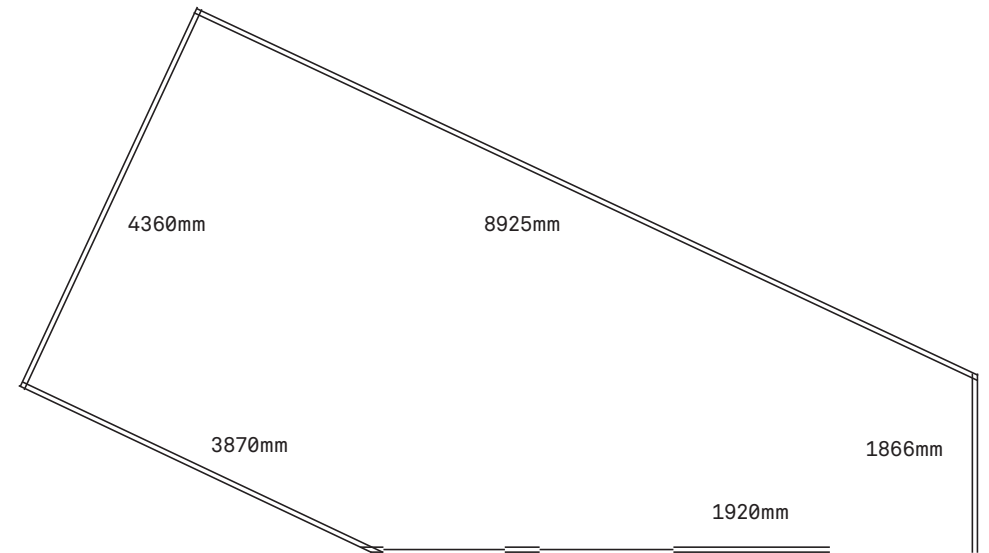

### Dimensions

892cm x 186cm x 398cm  
x 436cm

### Suitable For

Discussions  
Presentations  
Team development  
Away days  
Meetings

### Capacities

Lecture for 30  
Meeting for 12  
Workshop for 10

### Features

Floor sunken  
electricity supply  
Solid wood floor  
Adjustable lighting

ARCHIVE EXHIBITION

# ERWIN WURM: ONE MINUTE SCULPTURES

*"The fundamental steps consisted of abandoning the idea of durability and infinity. Sculpture could also last for just a few minutes, a few seconds. The works were transported to the level of the immediate present."*  
Erwin Wurm

Open Eye Gallery is proud to present the UK's first solo exhibition of Erwin Wurm's (b. Austria) *One Minute Sculptures*. Since the late 1990s the artist has been developing this ongoing series, in which he and his models pose with everyday objects. The works are spontaneously improvised, using everyday materials, and simply documented. In their combination of sculpture, performance and photography, these works represent a highly distinctive convergence of artistic traditions.

Wurm's *One Minute Sculptures* are playful, exuberant and comical. They assert that art can consist of the simplest gestures and materials, that it can be part of the flow of everyday life. But they also harbour dark and enigmatic undercurrents. Some like legs or obscure rituals. Their absurd, child-like logic implies a critique of social norms and values; they propose a momentary, anarchic alternative to the established order of things.

ARCHIVE EXHIBITION PARTNER

The Henry Moore  
Foundation



---

## COVERED PUBLIC REALM

The Gallery is set within a large covered glass space called the Covered Public Realm. This space can be used for larger events and was used for the gallery's launch in 2011 and summer previews of new exhibitions.

The Covered Public Realm is managed by Mann Island but can be booked directly through Open Eye Gallery, please ask the Operations Coordinator for prices and availability.

# 4

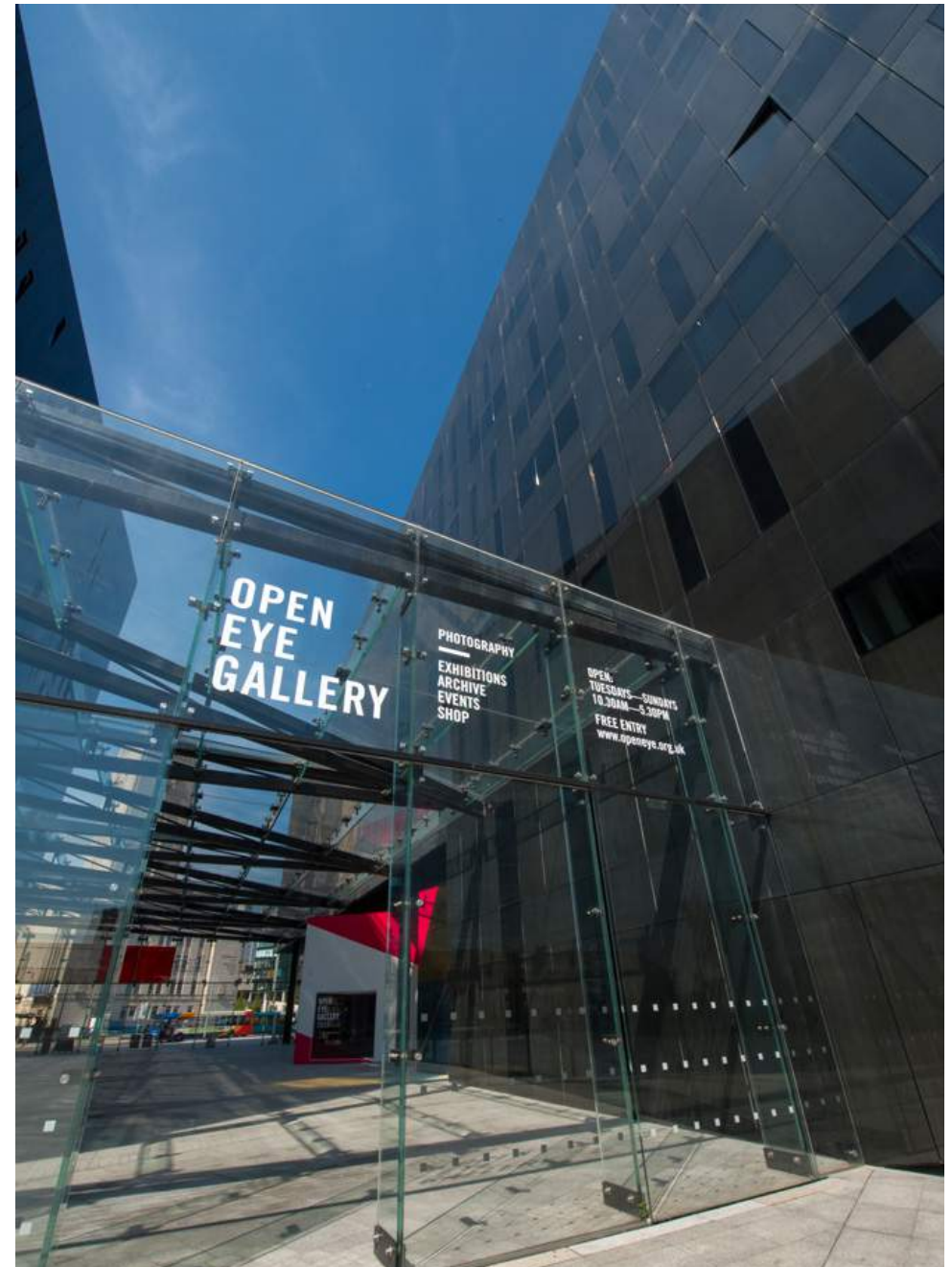



## SHOP

Open Eye Gallery runs a small Gallery Shop, specialising in Photography books, souvenirs, cards and analogue cameras. If you are looking to make your event unique and memorable we can create great gift packages for your clients to take away with them.

A ticketing service is available for your event via the online and in-store systems, please ask the Operations Coordinator for more details.

# SERVICES & RATES





## RATES

	Price	Times
Breakfast	£450	07.30 – 09.30
Half Day*	£550	12.00 – 16.00
Day*	£850	09.00 – 18.00
Evening	£450	19.00 – 22.00

\* Only available on Mondays, all times can be extended/negotiated.

N.B All rates include event staffing but are excluding catering staffing/costs.  
Charitable discounts available at the Gallery's discretion.

## IN HOUSE EQUIPMENT

The Gallery has the following equipment available to hire:

- 3 Projectors (1 HD)
- 63 inch projection screen
- 62 inch Plasma TV
- Flipchart
- 2 DSLR cameras
- Yamaha small powered speakers
- JBL small powered speakers
- 6 Apple Desktop Computers
- 6 pairs Sony Headphones

## EXTERNAL SUPPLIERS

Open Eye Gallery has an approved local supplier list for catering, additional furniture, AV equipment, lighting/sound engineers, merchandise design & production and professional printing. Value for money and standards are checked regularly and we welcome feedback from clients about the service received.

## ADDITIONAL SERVICES

With a wealth of experience programming gallery events the team at Open Eye can help to make your event really special, offering a variety of services from private gallery tours to bespoke workshops.

---

**“THE BEAUTIFUL SPACE, ORGANISED  
STAFF AND BRILLIANT LOCATION MADE  
THE EVENT A HUGE SUCCESS.”**

Cambridge University Press

**OPEN  
EYE  
GALLERY**

**PHOTOGRAPHY**  
—  
**EXHIBITIONS  
ARCHIVE  
EVENTS  
SHOP**

**OPEN:  
TUESDAYS—SUNDAYS  
10.30AM—5.30PM**

**FREE ENTRY  
[www.openeye.org.uk](http://www.openeye.org.uk)**

# CONTACT US

---

Open Eye Gallery  
19 Mann Island  
Liverpool Waterfront  
Liverpool  
L3 1BP

Phone:  
+44 (0)151 236 6768

Email:  
[ceri@openeye.org.uk](mailto:ceri@openeye.org.uk)  
[www.openeye.org.uk](http://www.openeye.org.uk)

Open Eye Gallery receives  
regular revenue funding from



Images ©Mark McNulty  
Gallery Plans ©Eleanor Suggett